



### MANUALE D'ISTRUZIONI PLAFONIERA LED 3CCT IP65



MILANO

VERONA

#### Specifiche tecniche:

	MISURE	W	Lumen	AC/Hz	3CCT (SWITCH)	CRI	α	TEMP. LAVORO	FINITURA	FLICKER	DIMM.	CLASSE	IK
IP12PL4S	205*105*47mm	12	1200	AC180-250V Hz 50/60	3000/4000/6500K	80	120°	-20°+50°	BIANCA	FREE	NO	II	08
IP18PL4S	267*137*47mm	18	1850	AC180-250V Hz 50/60	3000/4000/6500K	80	120°	-20°+50°	BIANCA	FREE	NO	II	08
IP18PL4NS	267*137*47mm	18	1850	AC180-250V Hz 50/60	3000/4000/6500K	80	120°	-20°+50°	NERA	FREE	NO	II	08
IP12PL8S	Ø181*47mm	12	1200	AC180-250V Hz 50/60	3000/4000/6500K	80	120°	-20°+50°	BIANCA	FREE	NO	II	08
IP18PL8S	Ø222*47mm	18	1850	AC180-250V Hz 50/60	3000/4000/6500K	80	120°	-20°+50°	BIANCA	FREE	NO	II	08
IP18PL8NS	Ø222*47mm	18	1850	AC180-250V Hz 50/60	3000/4000/6500K	80	120°	-20°+50°	NERA	FREE	NO	II	08

Plafoniere a LED rotonde e ovali installabili facilmente a parete/soffitto. Corpo e diffusore V2 autoestinguente e Anti-UV in policarbonato termoplastico e staffa in lega di alluminio. Disponibile in due finiture: bianca e nera. Resistente agli urti.

1

#### MONTAGGIO

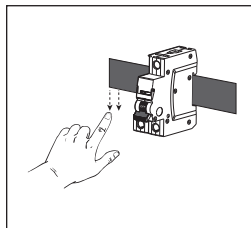

1. Scollegare la corrente elettrica.

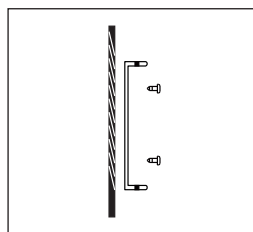

2. Effettuare i fori sul muro in base alla posizione del foro della staffa, posizionare la vite di espansione.

2

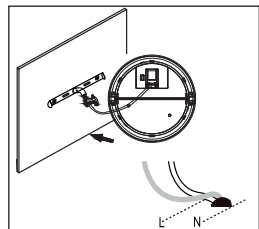

3. Scegliere la temperatura di utilizzo, connettere il cavo all'alimentazione.

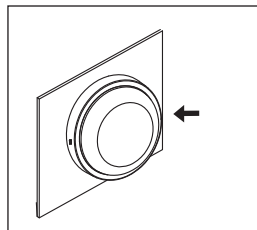

4. Fissare la lampada alla staffa.

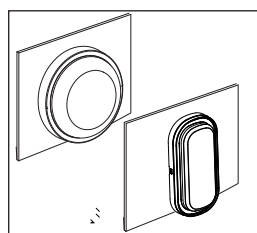

5. Accendere l'alimentazione dopo aver installato la lampada.

IP12PL4S

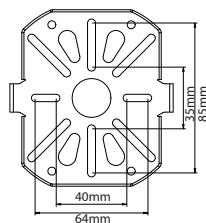

IP18PL4S

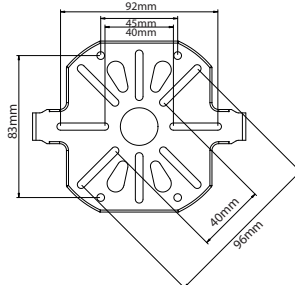

IP12PL8S-NS

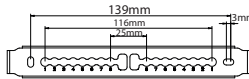

IP18PL8S-NS

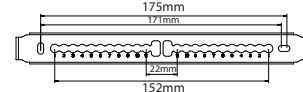

#### Informazioni sul riciclaggio in conformità con le direttive RAAE e batterie



Simbolo sul prodotto



Simbolo sulla batteria

Solo Europa

Il prodotto/batteria è contrassegnato con uno dei simboli di riciclaggio sopra indicati. Questo indica che a fine vita il prodotto/batteria, dovrà essere smaltito/a separatamente in appropriati luoghi di raccolta e non con i normali rifiuti domestici.

CE RoHs

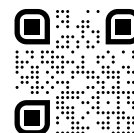

**IPERLUX®**  
www.iperlux.com  
info@iperlux.com

### INSTRUCTION MANUAL CCT LED BULKHEAD LIGHT IP65



MILANO

VERONA

#### Specifications and Technical Data sheet:

	SIZE	W	Lumen	AC/Hz	3CCT (SWITCH)	CRI	α	AMB. TEMP.	FINISH	FLICKER	DIMM.	CLASS	IK
IP12PL4S	205*105*47mm	12	1200	AC180-250V Hz 50/60	3000/4000/6500K	80	120°	-20°+50°	WHITE	FREE	NO	II	08
IP18PL4S	267*137*47mm	18	1850	AC180-250V Hz 50/60	3000/4000/6500K	80	120°	-20°+50°	WHITE	FREE	NO	II	08
IP18PL4NS	267*137*47mm	18	1850	AC180-250V Hz 50/60	3000/4000/6500K	80	120°	-20°+50°	BLACK	FREE	NO	II	08
IP12PL8S	Ø181*47mm	12	1200	AC180-250V Hz 50/60	3000/4000/6500K	80	120°	-20°+50°	WHITE	FREE	NO	II	08
IP18PL8S	Ø222*47mm	18	1850	AC180-250V Hz 50/60	3000/4000/6500K	80	120°	-20°+50°	WHITE	FREE	NO	II	08
IP18PL8NS	Ø222*47mm	18	1850	AC180-250V Hz 50/60	3000/4000/6500K	80	120°	-20°+50°	BLACK	FREE	NO	II	08

LED bulkhead light round and oval, easy to install on the wall or ceiling.  
ANTI-UV and V2 Self-extinguishing thermoplastic PC housing and diffuser and aluminium alloy bracket. Available in two finishes: white and black.  
Resistant to impacts.

It is recommended to contact a qualified electrician to install the product.

It is recommended not to touch the product when it is turned on.

In case of malfunction, disconnect the lamp from the power supply.  
It is recommended to contact an electrician and not try to repair the lamp yourself.

#### MOUNTING

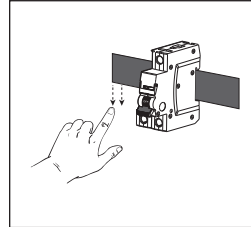

1. Switch off the power.

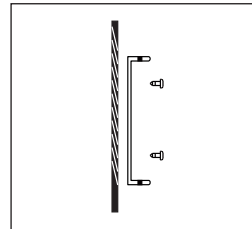

2. Trepanning on the wall according to the bracket hole position, put the expansion screw.

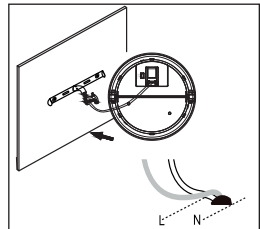

3. Choose the CCT temperature, connect the input wire to the production wire, reconnect metal bracket with fitting.

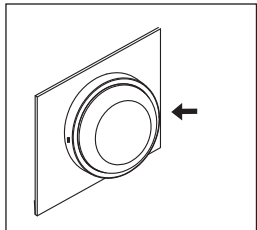

4. Fixed the lamp to the bracket.

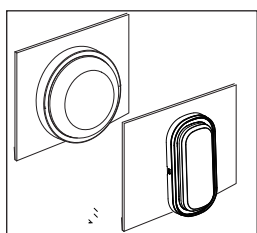

5. Switch on the power after installing the product.

IP12PL4S

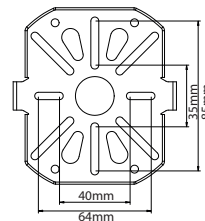

IP18PL4S

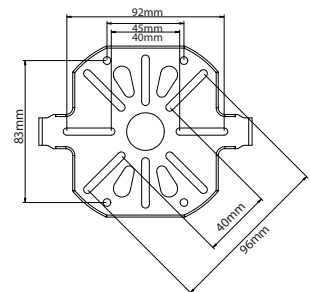

IP12PL8S-NS

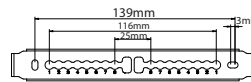

IP18PL8S-NS

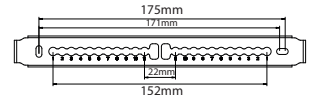

#### Recycling Information in Accordance with the WEEE and Battery Directives



Product Mark



Battery Mark

Europe only

The product/battery is marked with one of the above recycling symbols. It indicates that at the end of the life of the product/battery, you should dispose of it separately at an appropriate collection point and not place it in normal domestic waste stream.

CE RoHS

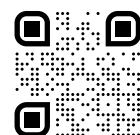

**IPERLUX®**  
www.iperlux.com  
info@iperlux.com